

THE TILDEN

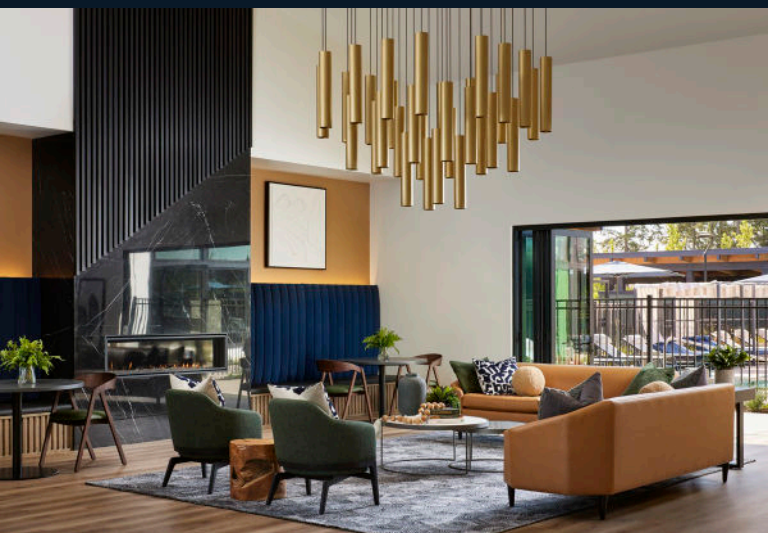

WELCOME HOME

The Tilden is at the center of the Puget Sound region and offers something for everyone. Convenient to schools and shops, The Tilden meets you where you are in your life. A short drive or bike ride away is the Nisqually National Wildlife Refuge, nearly 800 acres of protected trails, birding, and whale watching. Nearby Hawks Prairie Golf Course has 18-holes of fairways and lush hills. Area wineries, public parks, and trails offer fun diversions.

KEY AMENITIES

- FITNESS CENTER WITH PELOTON BIKES
- OUTDOOR POOL
- COVERED SPA
- THREE-SEASONS ROOM
- COVERED OUTDOOR BBQ & FIRE PITS
- BILLIARDS
- PLAY EQUIPMENT
- WALKING TRAILS
- GATED DOG PARK
- CLUBHOUSE WITH CATERER'S KITCHEN



YOUR HOME SEARCH ENDS AT TILDEN

Each home is designed to be a warm and welcoming place for you to gather and relax just outside Olympia in Lacey, a quintessentially Pacific Northwest community. Refined finishes and earthy palettes seamlessly reveal the natural beauty of the Northwest. Walk or hike through the Pacific ninebarks that give The Tilden its name, under a canopy of firs and cedars.

APARTMENT UNIT TYPES

SAPLING	1 BEDROOM 1 BATH 741-782 SF
ROOT	2 BEDROOM 1 BATH 912-921 SF
LEAF	2 BEDROOM 2 BATH 1049-1053 SF
BUD	2 BEDROOM 2 BATH 1060 - 1065 SF
BLOOM	3 BEDROOM 2 BATH 1181 SF

UNIT FEATURES

- AIR CONDITIONING
- HIGH-END FINISHES
- QUARTZ COUNTERTOPS
- SPACIOUS WALK-IN CLOSETS
- WASHER & DRYER IN EVERY UNIT
- SHOWCASE KITCHENS